

to let



UNIT 5, GREENHILLS BUSINESS CENTRE, ENTERPRISE WAY, SPENNYMOOR, CO. DURHAM, DL16 6BW

- WAREHOUSE / MANUFACTURING UNIT
- GIA – 2,590.60 M² (27,885 SQ FT)
- SECURE SELF CONTAINED ESTATE
- FLEXIBLE TERMS
- COMPETITIVE RENTS

LOCATION

Greenhills Business Centre is located on Green Lane Industrial Estate, Spennymoor, with easy access from the A177 approximately 3 miles from Junction 61 of the A1(M). Durham is located approximately 6 miles to the north and Darlington 15 miles to the south.

Green Lane Industrial Estate is a popular and established location with a number of local and national occupiers.

The exact location is shown on the attached plan.

DESCRIPTION

The Greenhills Business Centre comprises of a regular shaped site of approximately 20 acres and extended in total to 351,000 sq ft (32,585 sq m) comprising a selection of units.

The units are of steel portal frame construction with a pitched roof with elevations of insulated profile cladding. Internally the units benefit from an eaves height ranging from 6.3m to 7.3m.

The Business Centre is extensively secured by a perimeter fence, electronically operated access gate and CCTV system. Additionally there is a fully operational "wet/dry" sectional sprinkler system.

ACCOMMODATION

From onsite measurements the following areas have been calculated:

Unit 5	2,590.60 m ² (27,885 sq ft)
--------	--

RATING LIABILITY

The premises will need to be reassessed upon occupation.

(All interested parties should clarify these figures with the Local Rating Authority).

SERVICES

It's understood that all main services are available to the site.

TERMS

The premises are available by way of a new Full Repairing and Insuring Lease.

RENT

£2.50 per sq ft.

Incentives are available, subject to covenant strength and lease term.

SERVICE CHARGE

A service charge is payable for the maintenance and up keep of common areas

ENERGY PERFORMANCE CERTIFICATE

Upon request.

FURTHER INFORMATION

For information / assistance available for businesses within County Durham, please contact:

Business Durham - Tel: 0300 026 1261

VIEWING

By prior appointment with Frew Pain & Partners, contact:

James E F Pain

Tel: 07841 871710

Email: james.pain@frewpain.co.uk

February 2017

www.frewpain.co.uk t: 0191 229 9517 e: james.pain@frewpain.co.uk



Frew Pain & Partners, Collingwood Buildings,
38 Collingwood St, Newcastle upon Tyne, NE1 1JF



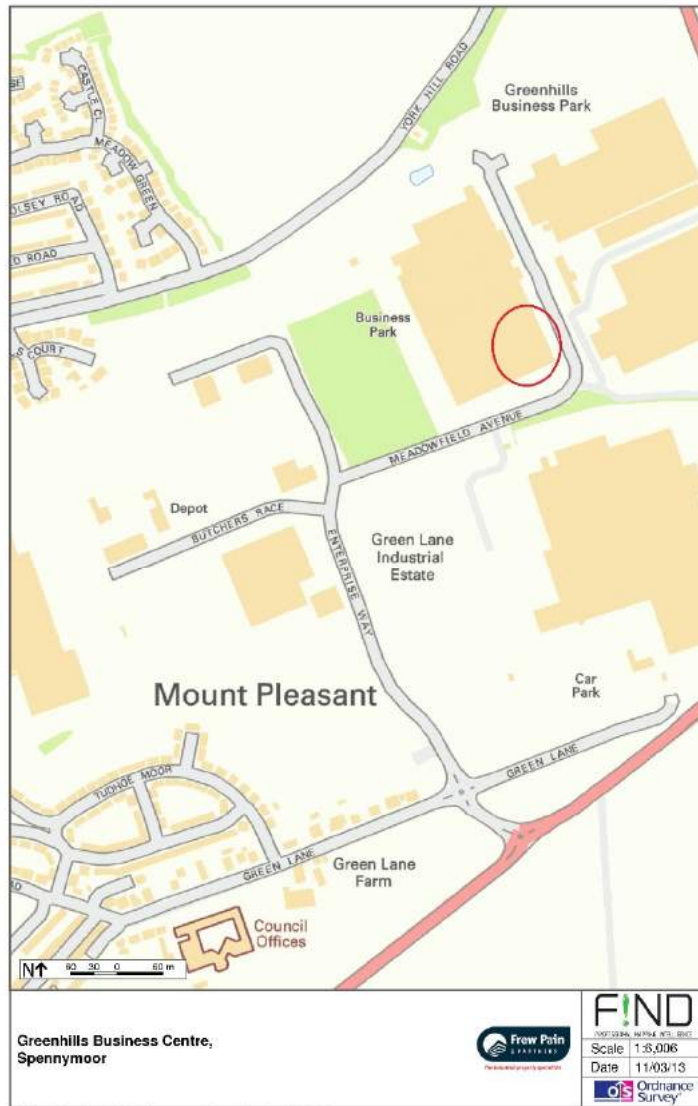
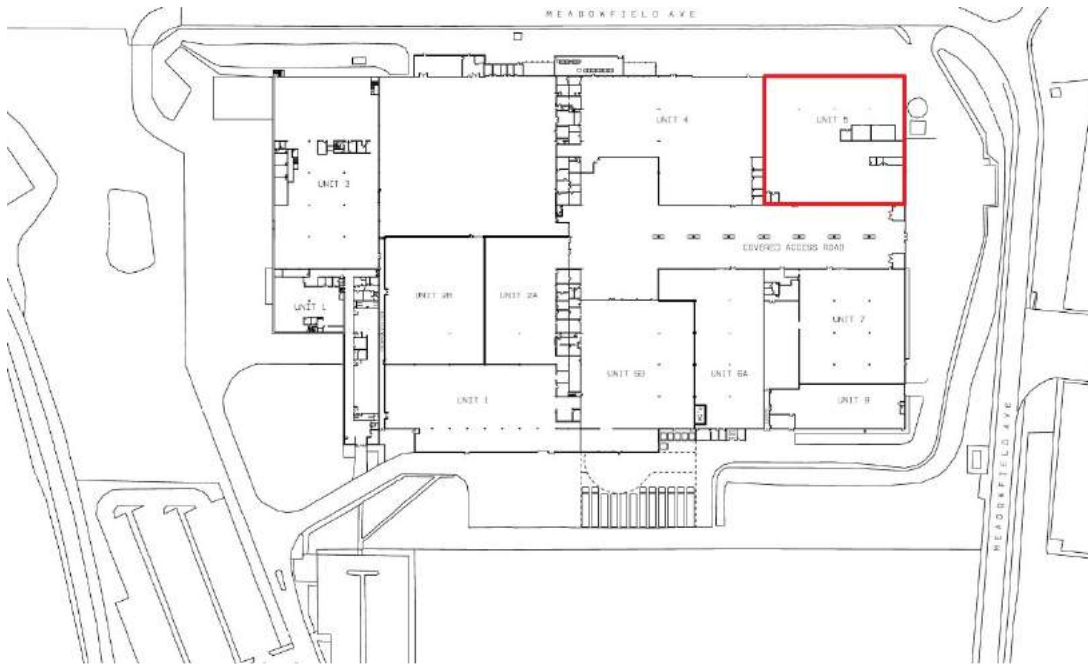

F492 Printed by Ravensworth 01670 713330

www.frewpain.co.uk t: 0191 229 9517 e: james.pain@frewpain.co.uk

IMPORTANT NOTICE: FREW PAIN & PARTNERS LTD for themselves and for the vendors and lessors of the property give notice that: (i) These particulars are set out as a general outline only for the guidance of intending purchasers or lessees and do not constitute, nor constitute part of any offer or contract. (ii) All descriptions, dimensions, reference to condition and necessary permissions for use and occupation and other details are given in good faith and are believed to be correct but without responsibility on the part of **FREW PAIN & PARTNERS LTD** or their clients. Any intending purchasers or tenants should not rely on them as statements or representations of fact but must satisfy themselves by inspection or otherwise as to the correctness of each of them. (iii) No person, either principal or employee, at **FREW PAIN & PARTNERS LTD** has any authority to make or give any representation or warranty in relation to this property. (iv) Any reference to plant, machinery, equipment, services, fixtures or fittings shall not imply that such items are fit for their purpose or in working order. **FINANCE ACT 1999**. Unless otherwise stated all prices and rents are quoted exclusive of VAT. **PROPERTY MISDESCRIPTIONS ACT 1991**: Every reasonable effort has been made by **FREW PAIN & PARTNERS LTD** to ensure accuracy. All interested parties are advised to take appropriate steps to verify by independent inspection or enquiry all information for themselves and to take the appropriate professional advice.